

Orcid – Connecting research and researchers

רישום וקבלת קוד ORCID

היכנסו לאתר: <https://orcid.org>

ולחצו על **register now**

Distinguish yourself in three easy steps

ORCID provides a persistent digital identifier (an ORCID iD) that you own and control, and that distinguishes you from every other researcher. You can connect your iD with your professional information — affiliations, grants, publications, peer review, and more. You can use your iD to share your information with other systems, ensuring you get recognition for all your contributions, saving you time and hassle, and reducing the risk of errors.

[FIND OUT MORE ABOUT OUR MISSION AND VALUES](#)

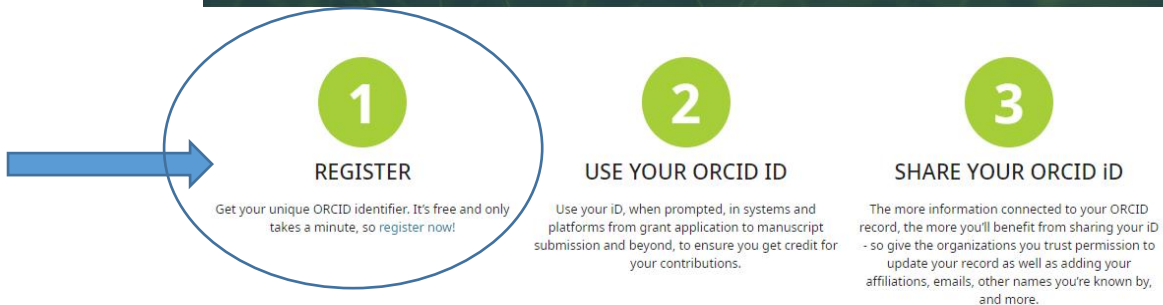

1. בשלב הראשון יש למלא את הפרטים הבאים: שם, וכתובת אי-מייל ראשית וללחוץ על **NEXT**

The screenshot shows the 'Create your ORCID iD' form, which is step 1 of 3. The form is titled 'Create your ORCID iD' and includes the following fields:

- First name:** Shoshana
- Last name (Optional):** (empty)
- Primary email:** oooo@emef.ac.il
- Confirm primary email:** oooo@emef.ac.il
- Additional email (Optional):** (empty)

At the bottom of the form, there are two buttons: 'GO BACK' and 'NEXT'. The 'NEXT' button is circled in red, indicating the next step in the process.

ייתכן ויופיע מסך עם שמות של חוקרים בעלי שמות דומים לשלכם, במקרה זה תופיע השאלה:
Could this be you?
 במידה ולא נרשמתם התעלמו משאלה זו והקליקו מטה להמשך הרישום.

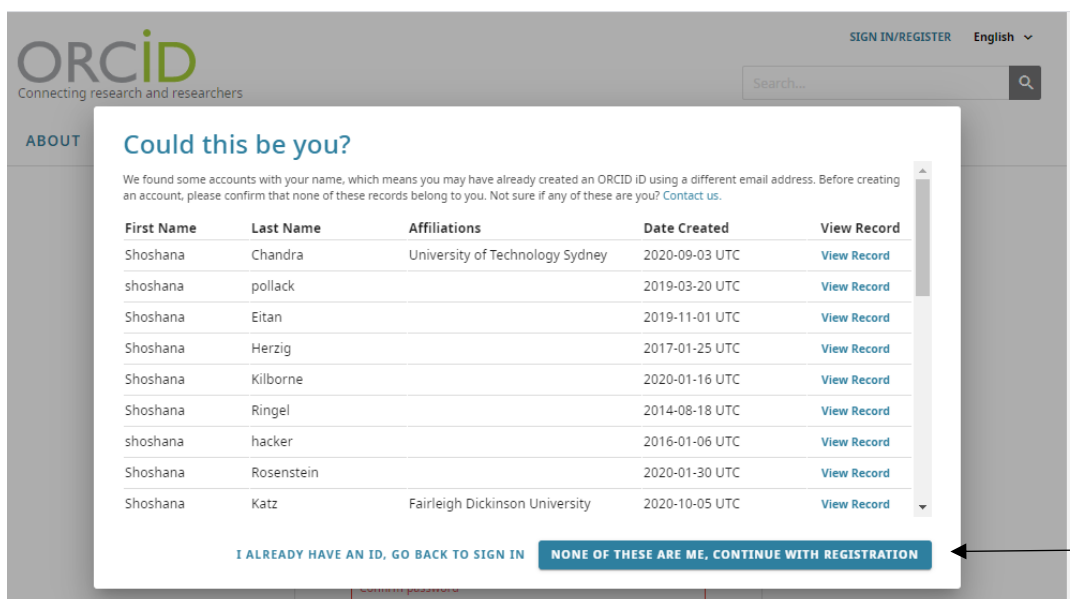

2. בשלב השני ניצור את הקוד האישי שלנו על ידי בחירת סיסמה בעלת 8 תווים לפחות הכוללת לפחות אות אחת, ספרה אחת וסימן אחד.

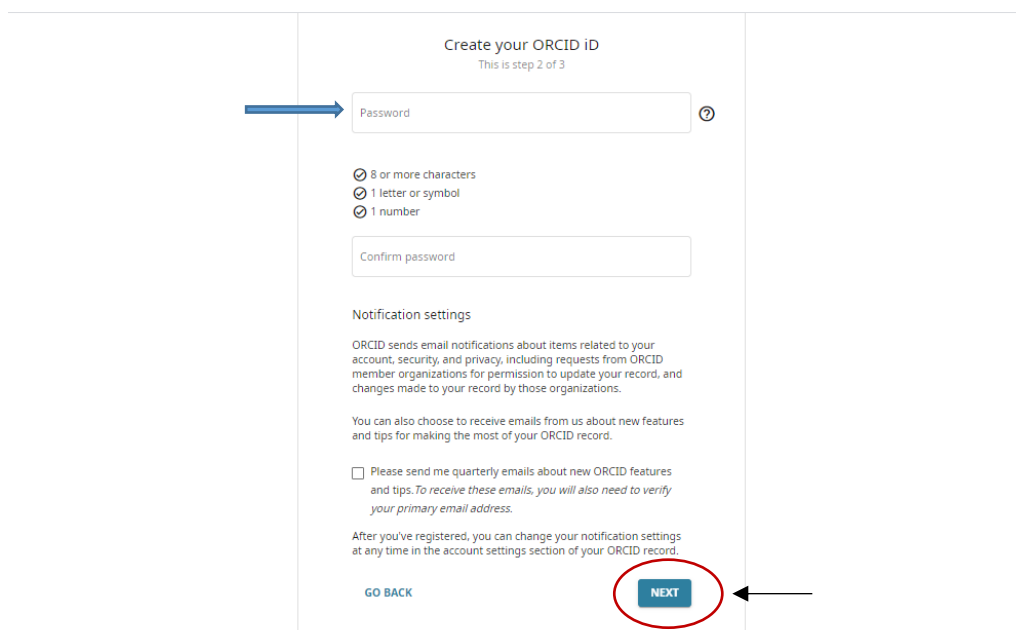

3. בשלב השלישי נשלים את תהליך הרישום על ידי בחירת הניראות לפעילות המחקרית, לשייכות מוסדית ועוד. השליטה על התוכן ועל מי שיוכל לראות את הנתונים, היא בידיך.

Create your ORCID iD
This is step 3 of 3

Visibility settings

Your ORCID iD connects with your ORCID record that can contain links to your research activities, affiliations, awards, other versions of your name, and more. You control this content and who can see it.

By default, what visibility should be given to new items added to your ORCID Record?

Everyone (87% of users choose this)

Trusted Organizations (5% of users choose this)

Only me (8% of users choose this)

[More information on visibility settings](#)

Terms of Use

I consent to the [privacy policy](#) and [terms of use](#) including agreeing to my data being processed in the US and being publicly accessible where marked as "visible to Everyone".

I'm not a robot

[GO BACK](#) [REGISTER](#)

לאחר בחירת ההגדרה הרצויה והסכמה לתנאי שימוש יש לחוץ על **REGISTER**

4. בסוף התהליך לפני התחלת הוספת מידע על פי רצונכם יש צורך לאישור סופי באי-מייל:

ABOUT FOR RESEARCHERS MEMBERSHIP DOCUMENTATION RESOURCES NEWS & EVENTS

Thank you for registering. We have sent verification messages to each of your registered email addresses. You will need to verify your primary email address before you can begin adding information manually to your ORCID record.

[Resend verification email](#)

Shoshana Biography

ORCID iD
<https://orcid.org/0000-0001-9222-6311>
View public version

Display your ID on other sites
Public record print view
Get a QR Code for your ID
Also known as
Country
Keywords
Websites & Social Links
Other IDs

Employment (0) + Add employment II Sort
Employment lists organizations where you have been professionally affiliated. Add employer.

Education and qualifications (0) + Add qualification + Add education II Sort
Education lists the organizations where you were educated. Add education or add qualification.

Invited positions and distinctions (0) + Add invited position + Add distinction II Sort
An invited position is an invited non-employment affiliation. A distinction is an honorary or other award, distinction, or prize. Add invited position or add distinction.

Membership and service (0) + Add service + Add membership II Sort
Membership is membership in any society or organization. Service is a dedication of time, money, or other resources. Add membership or add service.

Funding (0) + Add funding II Sort
Funding captures grants and other awards you have received to support your research. Add funding.

Works (0 of 0) + Add works II Sort
Works captures your research outputs, e.g. publications, conference presentations, data sets, and more. Add works.

לקבלת עזרה נוספת ניתן לפנות למידענית: libefr@emef.ac.il - שושנה ביר - טל: 02-565-1907